

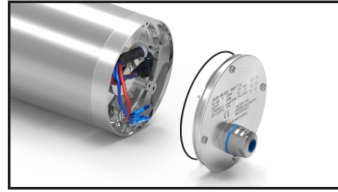

Technical data

IEC 63..90L, 4 poles
 Δ/Y 230/400V/50Hz
 I.CI.F – IP67 - IC410
 Efficiency IE3 (IEC60034-30, IEC60034-2-1 Pn ≥ 0,75kW)
 Duty S1
 Stainless steel AISI316L construction
 Degree of protection IP67
 INVERTER DUTY
 HYGIENIC
 PTO PROTECTION INCLUDED

Large terminal box for an easy and quick cable connection



IP67 and VITON® O-ring on all removable parts



Standard stainless steel cable gland EHEDG certified



B14

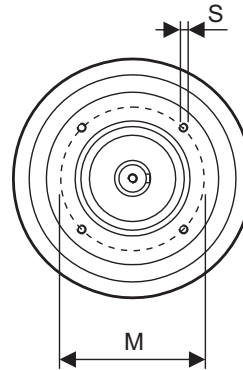
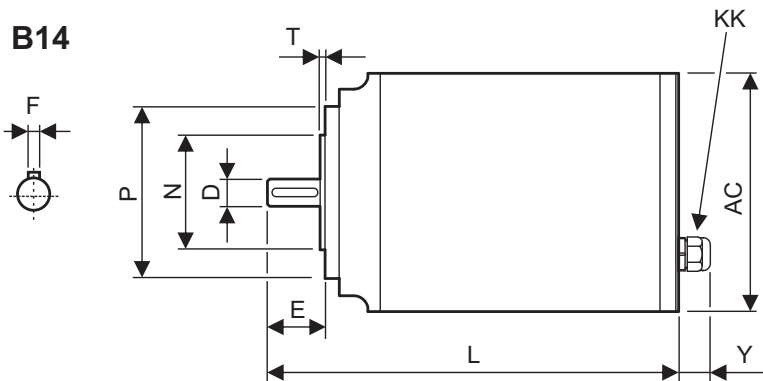

B5

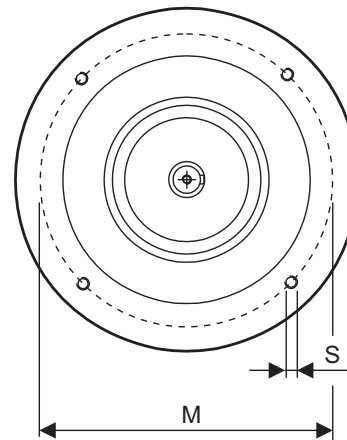
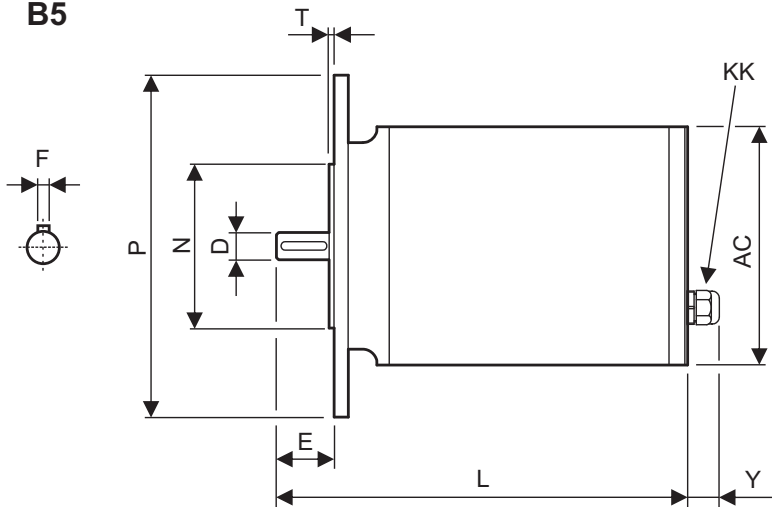

Motor	KK
63	M16x1.5 ø5-10
71	M20x1.5 ø7-13
80	
90	M25x1.5 ø10-14

4 poles

4 poles												B5					B14						
Motor	kW	rpm min ⁻¹	Nm	A (400V)	COS (φ)	D	F	E	L	AC	Y	N	M	P	T	S	Kg	N	M	P	T	S	Kg
63A	0.12	1440	0.80	0.44	0.57	11 j6 M4	4	23	229	131	24	95 j6	115	140	3	4x10	9.4	60 j6	75	90	2.5	4xM5	8.7
63B	0.18		1.19	0.58	0.62				244								10.7						
71A	0.25	1440	1.66	0.72	0.64	14 j6 M5	5	30	266	131	27	110 j6	130	160	3.5	4x10	12.5	70 j6	85	105	2.5	4xM6	11.6
71B	0.37		2.45	1.1					286								14.4						
80A	0.55	1460	3.60	1.5	0.67	19 j6 M6	6	40	280	166	27	130 j6	165	200	3.5	4x12	21.0	80 j6	100	120	3	4xM6	19.0
80B	0.75		4.91	2.1					305								24.0						
90S	1.1	1460	7.20	2.9	0.70	24 j6 M8	8	50	345	166	30	130 j6	165	200	3.5	4x12	28.5	95 j6	115	140	3	4xM8	27.0
90L	1.5		9.81	4.0					390								34.5						